

NOTES
 NO. DESCRIPTION

REVISIONS

NO.	DATE	REMARKS
1.	23 SEP 2014	REZONING SUBMISSION
2.	10 DEC 2015	DE SUBMISSION

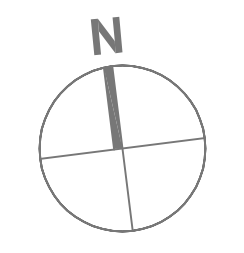

495 W. KING EDWARD AV.
 VANCOUVER, BC

RESIDENTIAL DEVELOPMENT

SITE PLAN

DATE	DECEMBER, 2015
DRAWN BY	AJE
CHECKED BY	--
SCALE	3/32" = 1'-0"
JOB NUMBER	1409

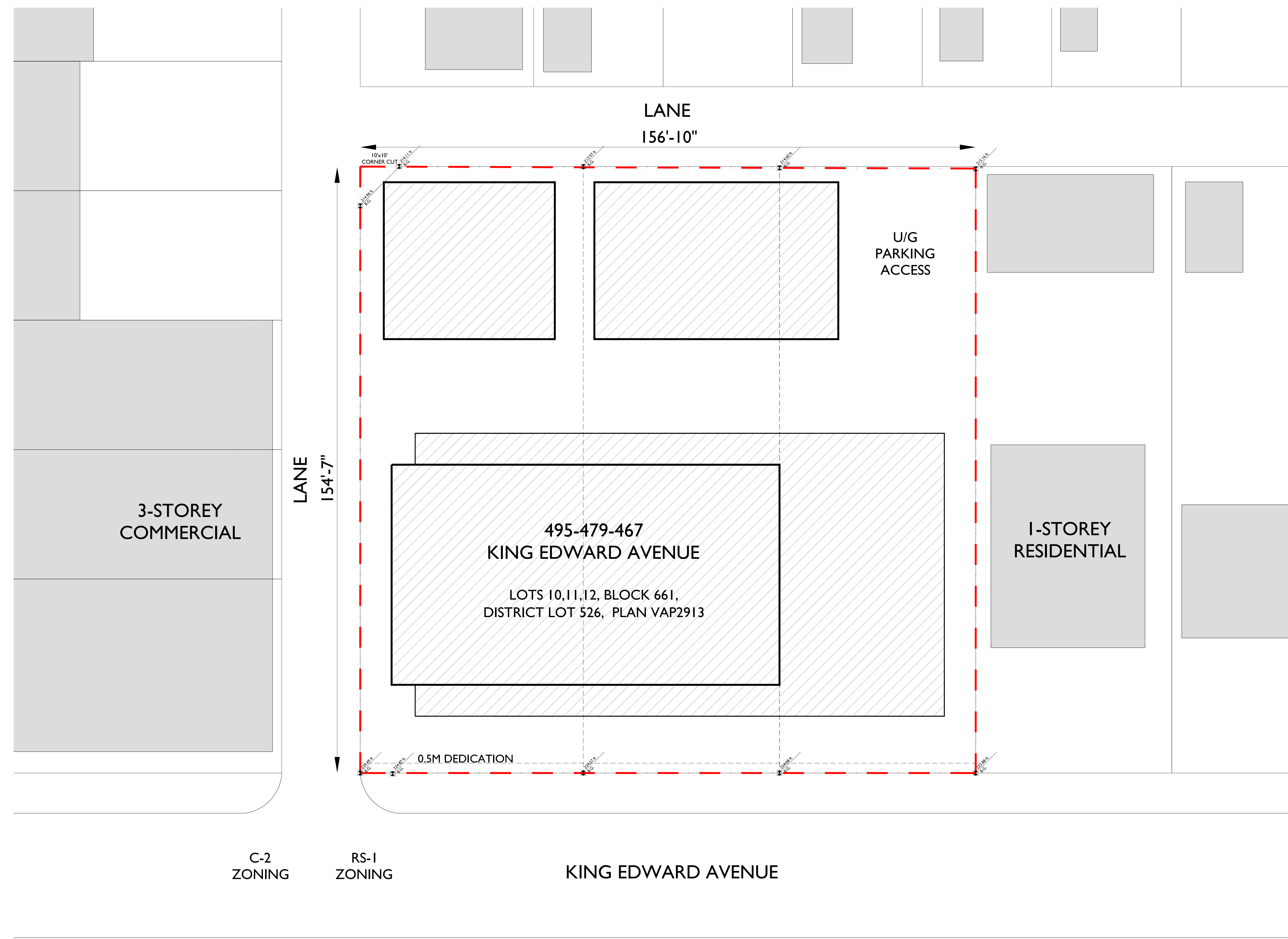

C-2
 ZONING

RS-1
 ZONING

KING EDWARD AVENUE

495-479-467
 KING EDWARD AVENUE
 LOTS 10,11,12, BLOCK 661,
 DISTRICT LOT 526, PLAN VAP2913

U/G
 PARKING
 ACCESS

I-STOREY
 RESIDENTIAL

3-STOREY
 COMMERCIAL

LANE
 156'-10"

LANE
 154'-7"

0.5M DEDICATION

10x10'
 CORNER CUT