

1.1 Design Rationale

The proposed renovations and additions to the BCCW campus are to accommodate:

- The relocation of Sunny Hill Health Centre for Children (Sunny Hill) onto the C&W Oak Street Campus,
- The incorporation of a new therapy pool and rehabilitation garden located on level 1 to support the new Sunny Hill programs,
- An additional 10 maternity beds utilizing the Single Room Maternity Care (SRMC) model,
- The relocation of the existing substance Use Inpatient Unit (FIR) from BCCW level 2 to level 3 to improve operations and to allow for SRMC beds within the vacated space.

Sunny Hill Health Centre for Children (Sunny Hill) offers specialized diagnostic and therapeutic services to children and adolescents from across the province experiencing complex developmental and neurological conditions and disabilities including:

- Neuromotor conditions;
- Acquired brain injury;
- Sensory deficits;
- Spinal cord injuries or spinal defects;
- Complex medical/surgical cases; and
- Complex cases of chronic pain and functional neurological symptom disorder.

Sunny Hill is currently located 8 kilometers from the Oak Street Campus. This separation creates issues for patient care and inefficiencies for staff. Patients are transferred between Sunny Hill and BC Children's (back and forth in the same day at times) to enable access to care, such as surgery, radiology procedures, rehabilitation services, and outpatient clinic follow-up. Delivering Sunny Hill services on the main Oak Street campus will reduce burden on patients and families and increase collaboration amongst health care professionals. In addition, Sunny Hill operates in buildings which are long past their useful life (original building from 1931) and require extensive investment to upgrade.

BC Women's provides both low and high risk birthing and have since 1998 offered low risk birthing in a Single Room Maternity Care model. This model of care is considered to be the standard of care for low risk birthing. The existing capacity of 17 beds is consistently full and as a result, low risk births are delivered in high risk Labour and Delivery rooms which do not offer the range of options to enable low risk, low intervention births. An additional 10 beds is required to bring the SRMC complement to 27 beds and to preserve the high acuity capacity for patients that require a high risk environment. . The creation of the 10 new SRMC beds necessitates two decanting moves. The Perinatal Substance Use inpatient unit (FIR) is displaced to Level 3 allowing the Balsam postpartum unit to move into the vacated FIR space on Level 2. This allows for demolition of the previous Balsam unit and construction of 10 new SRMC rooms.

The Site

The project site involves:

- Level 1 and 3 renovations in vacated spaces noted as areas A, B, C, D, and E with the Children's Hospital
- Demolition of the existing ICU building located along the west façade of level 1 Children's Hospital with the replacement of a new therapy pool and rehabilitation garden. The site surrounding the existing ICU building is fairly flat with existing green space and trees. An existing generator located with the existing space will remain however, some screening will be provided. Access to the generator will need to be maintained to accommodate vehicles for general maintenance.
- Addition of a roof plaza with garden planter boxes located on the Level 3 roof of the existing Children's Hospital to support the new relocated FIR program
- Addition of the existing SRMC at Level 2 of Women's Hospital, the site is flat in the area where the addition will be provided and will not be enclosed at level 1.

Building Form

Providing a diverse array of apparatuses, equipment, ground cover and play areas to support the clinical needs of the children. The pool will sit within the rehabilitation garden and be visible from within the garden and within the level 1 outpatient services. The outdoor space will be directly connected to the interior of level 1 to allow family and children to watch and be engaged with the activities. The entire rehabilitation garden will be enclosed for privacy and screened from the existing roadways and walkways around the C&W campus, and for protecting the children from running out into traffic or leaving the secured areas.

The therapy pool is a one-story building with a mezzanine mechanical level and a basement mechanical room. The building is a soft free form that is non-intimidating to children and glazed to allow connection to the outdoor spaces. The pool roof curves along the south façade and tapers down towards the outdoor space to reduce the scale of the building.

Along the north side of the outdoor space is a circular form concrete ramp that is used for children to test wheel chairs and to experience being at different heights. The circular form is expressed along the parameter, connects with the main entry to the campus and assists with identify the main entry to Sunny Hill.

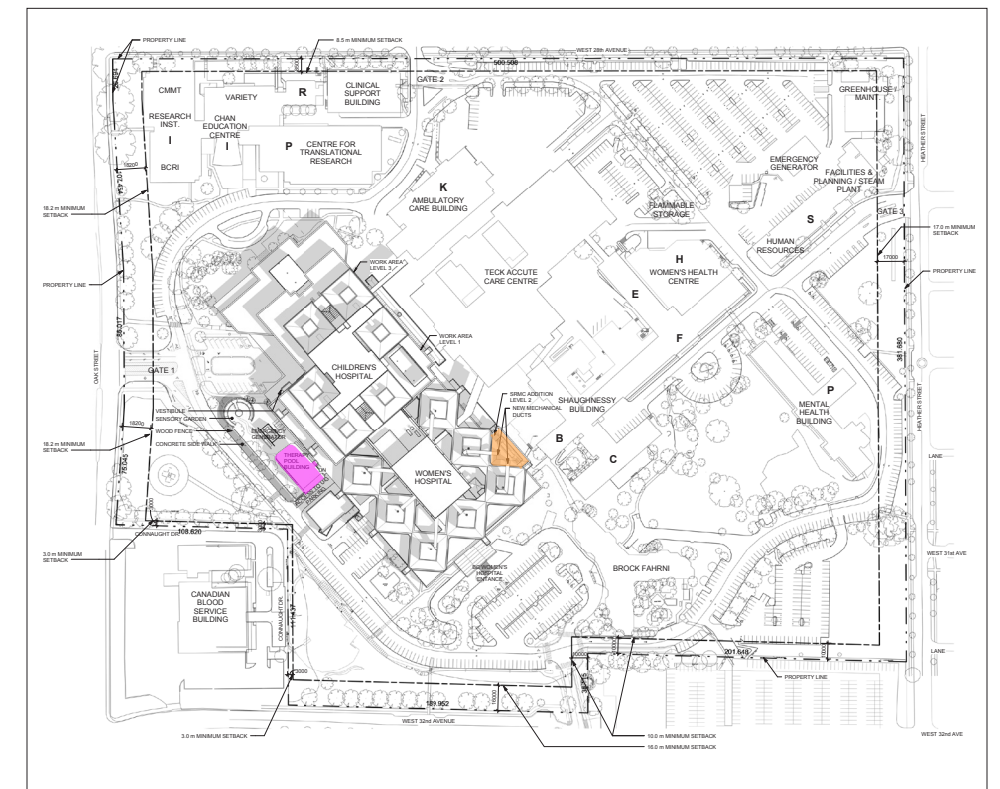

Site Context Map

New Therapy Pool ■
SRMC ■