

TOWER PLACEMENT - OPTION A

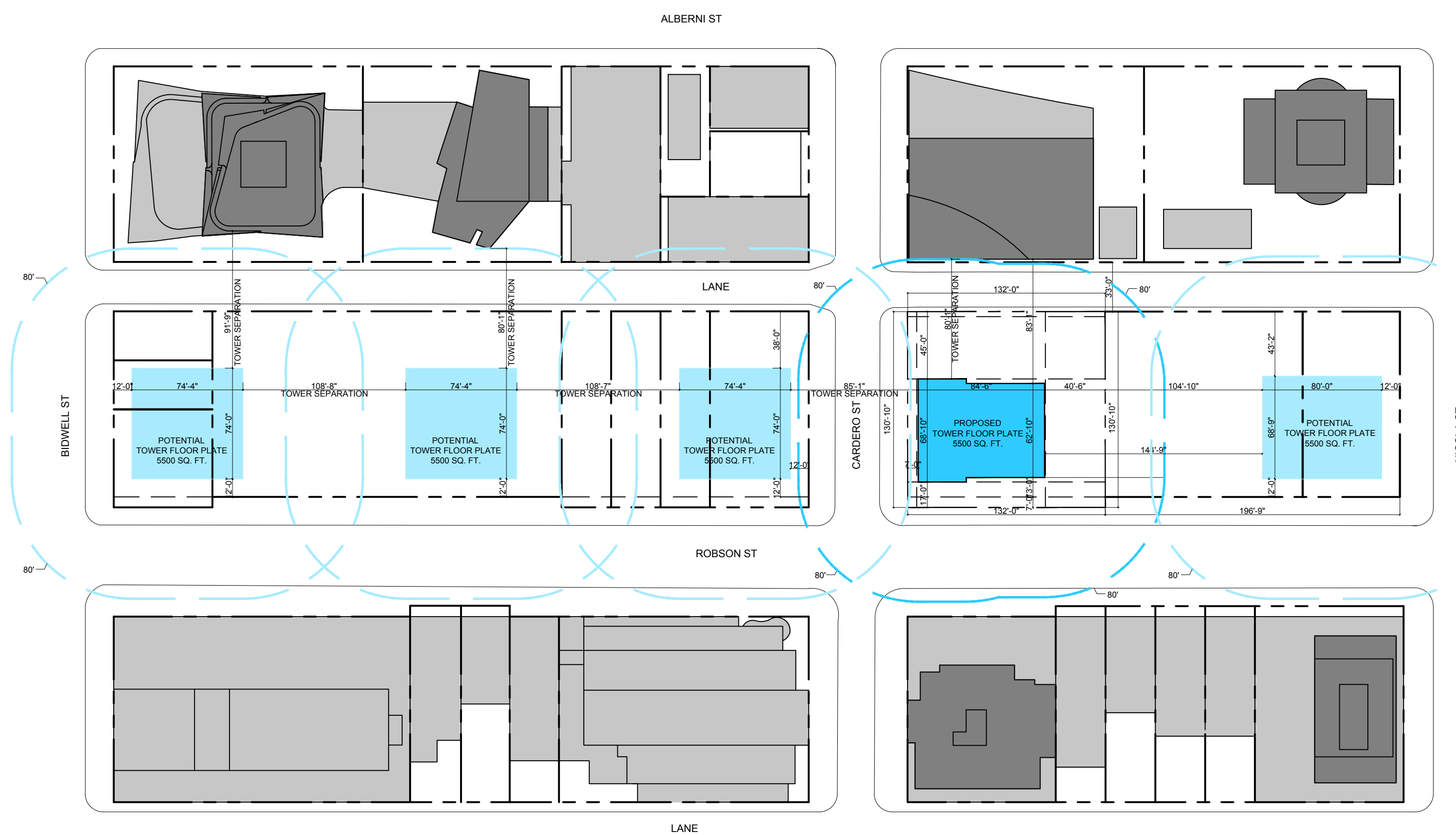

TOWER PLACEMENT - OPTION B

CLIENT  
**VKJ (CARDERO)**  
**INVESTMENT LP**  
 550 - 601 WEST BROADWAY  
 VANCOUVER, BC V5Z 4C2

**COPYRIGHT:**  
 Any reproduction or distribution for any purpose other than authorized by IBI Group is forbidden. Written dimensions shall have precedence over scaled dimensions. Contractors shall verify and be responsible for all dimensions and conditions on the job and IBI Group shall be informed of any variations from the dimensions and conditions shown on the drawing. Shop drawings shall be submitted to IBI Group for approval before proceeding with fabrication.  
**IBI Group Architects (Canada) Inc.**  
 is a member of IBI Group of companies

NO.	DATE	DESCRIPTION
1	2018-07-05	DP SUBMISSION

NO.	DATE	APPR	DESCRIPTION

**REVISIONS**

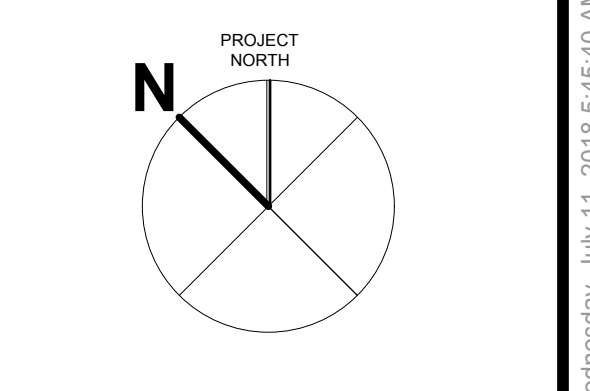

SEAL

SUB-CONSULTANT

PRIME CONSULTANT  
**IBI GROUP ARCHITECTS (CANADA) INC.**  
 700 - 1285 West Pender Street  
 Vancouver BC V6E 4B1 Canada  
 tel 604 683 8797 fax 604 683 0492  
 ibigroup.com

PROJECT TITLE  
**ROBSON & CARDERO**  
 1555 ROBSON STREET

PROJECT NO: 113012  
 DRAWN BY: User  
 CHK'D BY: User  
 SCALE: 1/64"=1'-0"  
 DATE: 2018/07/05

SHEET TITLE  
**TOWER PLACEMENT**

SHEET NUMBER  
**A0.03**  
 1 OF 1

File Location: J:\113012\_1555Robson\03 Drawings\Search\client\ACAD\Sheets\A0.03 Tower Placement.dwg Last Saved: July 9, 2018, by maryam.dehکرد - Plotted: Wednesday, July 11, 2018 5:45:40 AM by Maryam Dehکرد

**COPYRIGHT:**  
 Any reproduction or distribution for any purpose other than authorized by IBI Group is forbidden. Written dimensions shall have precedence over scaled dimensions. Contractors shall verify and be responsible for all dimensions and conditions on the job and IBI Group shall be informed of any variations from the dimensions and conditions shown on the drawing. Shop drawings shall be submitted to IBI Group for approval before proceeding with fabrication.  
**IBI Group Architects (Canada) Inc.**  
 is a member of IBI Group of companies

NO.	DATE	DESCRIPTION
1	2018-07-05	DP SUBMISSION

NO.	DATE	APPR	DESCRIPTION

**REVISIONS**

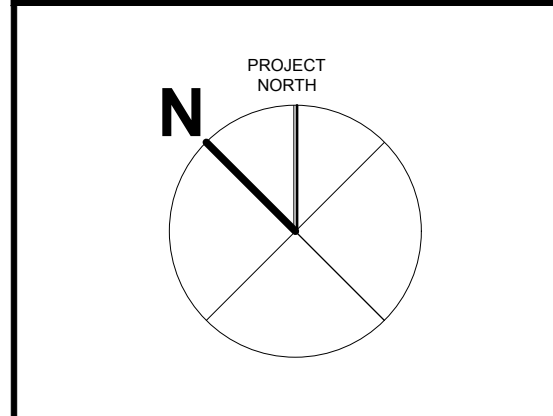

SEAL

SUB-CONSULTANT

PRIME CONSULTANT

**IBI GROUP ARCHITECTS (CANADA) INC.**  
 700 - 1285 West Pender Street  
 Vancouver BC V6E 4B1 Canada  
 tel 604 683 8797 fax 604 683 0492  
 ibigroup.com

PROJECT TITLE  
**ROBSON & CARDERO**  
 1555 ROBSON STREET

PROJECT NO:	113012
DRAWN BY:	User
CHK'D BY:	User
SCALE:	1/64"=1'-0"
DATE:	2018/07/05

SHEET TITLE  
**CONTEXT PLAN**

SHEET NUMBER	REV:
<b>A0.05</b>	----
1 OF 1	

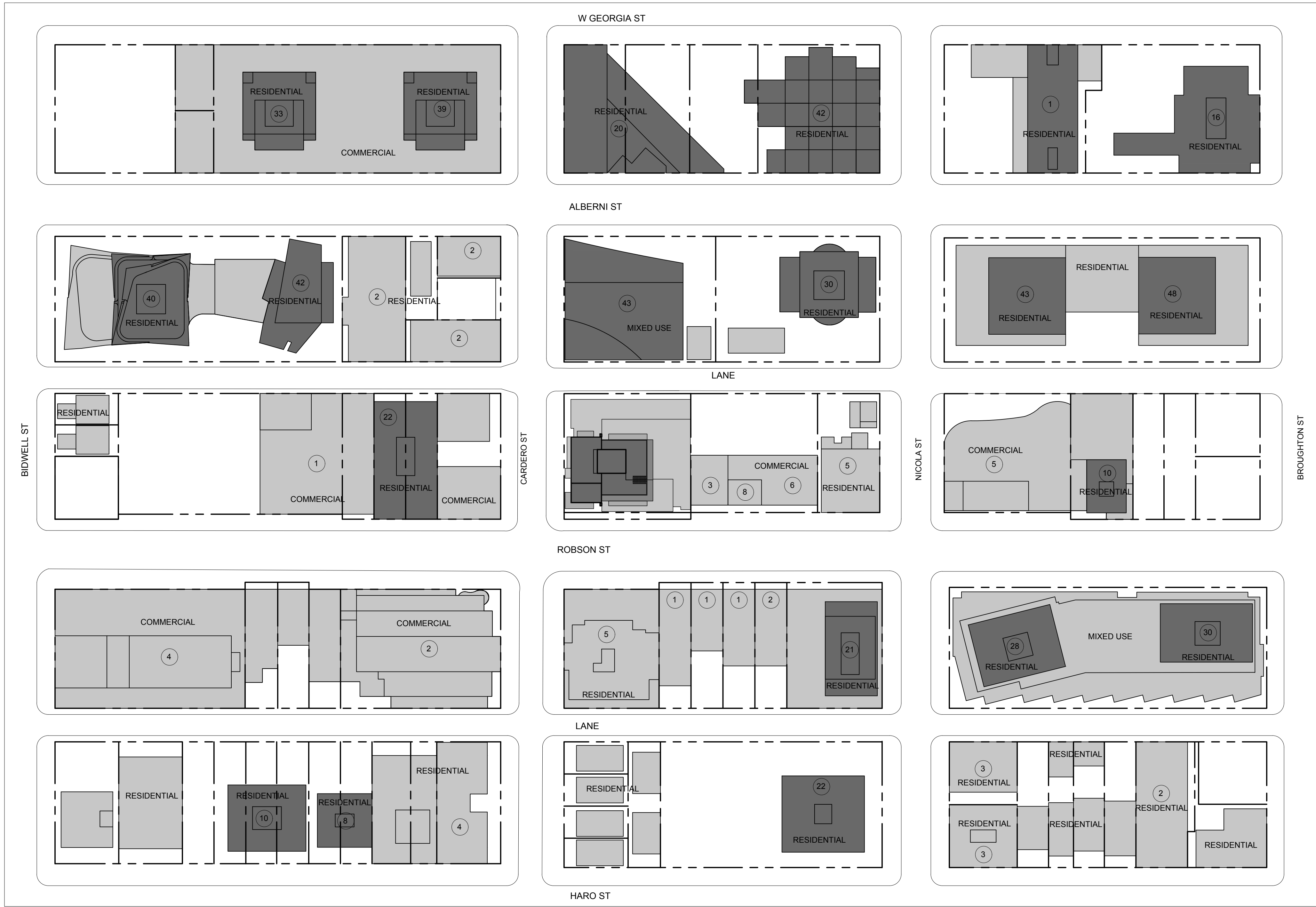

# NO. OF STOREYS