

PLANT SCHEDULE

KEY	QTY	BOTANICAL NAME	COMMON NAME	PLANTED SIZE / REMARKS
TREE				
1		ACER PALMATUM 'ORANGE DREAM'	JAPANESE MAPLE	2.5M HT; B&B
2		CERCIS CANADENSIS 'FOREST PANSY'	FOREST PANSY REDBUD	5CM CAL; B&B
2		STYRAX JAPONICUS 'PINK CHIMES'	PINK FLOWERED JAPANESE SNOWBELL	6CM CAL; 1.8M STD; B&B
SHRUB				
A1	2	AZALEA 'SPICY LIGHTS'	DECIDUOUS AZALEA; ORANGE	#3 POT; 40CM
B1	112	BUXUS MICROPHYLLA 'WINTER GEM'	LITTLE-LEAF BOX	#3 POT; 40CM
C1	6	CALLICARPA BODINIERI 'PROFUSION'	BEAUTYBERRY	#3 POT; 60CM
C2	15	CEANOTHUS THYRSIFLORUS 'VICTORIA'	CALIFORNIA LILAC	#7 POT; 70CM
C3	3	HYDRANGEA SERRATA 'BLUEBIRD'	MOUNTAIN HYDRANGEA; LACECAP BLUE	#3 POT; 40CM
C4	9	RHODODENDRON 'CHRISTMAS CHEER'	RHODODENDRON; BLUSH PINK	#3 POT; 50CM
C5	3	SKIMMIA JAPONICA (10% MALE)	JAPANESE SKIMMIA	#3 POT; 50CM
C6	61	TAXUS X MEDIA 'HICKSII'	HICK'S YEW	1.5M B&B
C7	22	VACCINIUM OVATUM	EVERGREEN HUCKLEBERRY	#3 POT; 60CM
C8	27	VIBURNUM DAVIDII	DAVID'S VIBURNUM	#2 POT; 30CM
C9	1	VIBURNUM P.T. 'SUMMER SNOWFLAKE'	SUMMER SNOWFLAKE VIBURNUM	#3 POT; 60CM

PLANT SCHEDULE

KEY	QTY	BOTANICAL NAME	COMMON NAME	PLANTED SIZE / REMARKS
GRASS				
HS	6	HELICTOTRICHON SEMPERVIRENS	BLUE OAT GRASS	#1 POT
PO	34	PENNISETUM ORIENTALE	ORIENTAL FOUNTAIN GRASS	#1 POT
PERENNIAL				
H	17	HOSTA FORTUNEI 'FRANCEE'	HOSTA; GREEN AND WHITE VARIEGATED	#1 POT; 1 EYE
I	131	IBERIS SEMPERVIRENS 'SNOWFLAKE'	SNOWFLAKE EVERGREEN CANDYTUFT	9CM POT
L	2	LAVENDULA ANGUSTIFOLIA 'HIDCOTE BLUE'	ENGLISH LAVENDER; COMPACT; DEEP PURPLE	#1 POT
OS				
PM	34	POLYSTICHUM MUNIUM	WESTERN SWORD FERN	#1 POT; 25CM
W	16	WALDSTEINIA TERNATA	BARREN STRAWBERRY	#1 POT; 20CM

NOTES: * PLANT SIZES IN THIS LIST ARE SPECIFIED ACCORDING TO THE BC LANDSCAPE STANDARD AND CANADIAN LANDSCAPE STANDARD, LATEST EDITION. CONTAINER SIZES SPECIFIED AS PER CNLA STANDARD. BOTH PLANT SIZE AND CONTAINER SIZE ARE THE MINIMUM ACCEPTABLE SIZES. * REFER TO SPECIFICATIONS FOR DEFINED CONTAINER MEASUREMENTS AND OTHER PLANT MATERIAL REQUIREMENTS. * SEARCH AND REVIEW: MAKE PLANT MATERIAL AVAILABLE FOR OPTIONAL REVIEW BY LANDSCAPE ARCHITECT AT SOURCE OF SUPPLY. AREA OF SEARCH TO INCLUDE LOWER MAINLAND AND FRASER VALLEY. * SUBSTITUTIONS: OBTAIN WRITTEN APPROVAL FROM THE LANDSCAPE ARCHITECT PRIOR TO MAKING ANY SUBSTITUTIONS TO THE SPECIFIED MATERIAL. UNAPPROVED SUBSTITUTIONS WILL BE REJECTED. ALLOW A MINIMUM OF FIVE DAYS PRIOR TO DELIVERY FOR REQUEST TO SUBSTITUTE. SUBSTITUTIONS ARE SUBJECT TO BC LANDSCAPE STANDARD AND CANADIAN LANDSCAPE STANDARD - DEFINITION OF CONDITIONS OF AVAILABILITY. ALL LANDSCAPE MATERIAL AND WORKMANSHIP MUST MEET OR EXCEED BC LANDSCAPE STANDARD AND CANADIAN LANDSCAPE STANDARD LATEST EDITION. ALL PLANT MATERIAL MUST BE PROVIDED FROM CERTIFIED DISEASE FREE NURSERY.

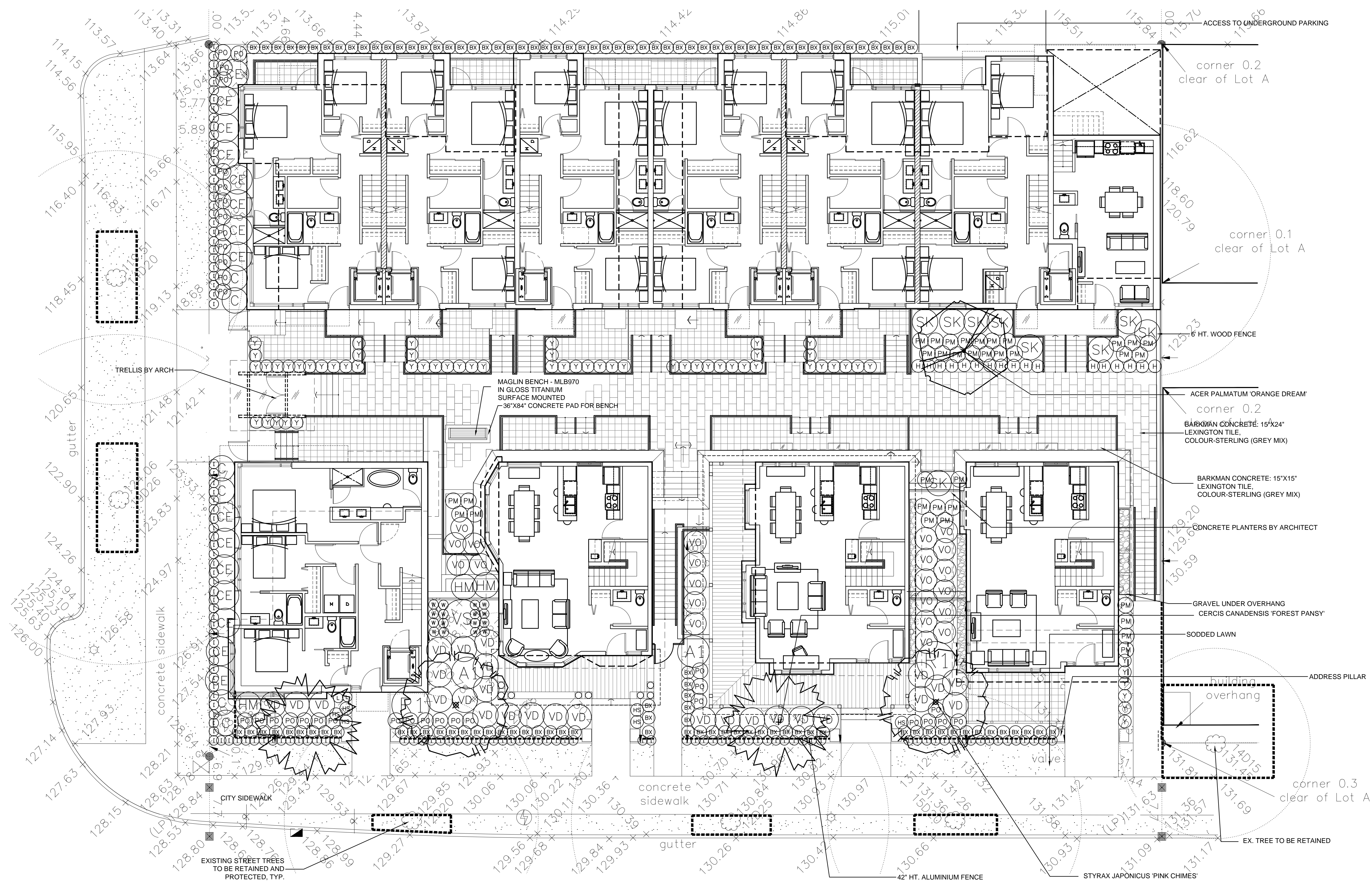

© Copyright reserved. This drawing and design is the property of PMG Landscape Architects and may not be reproduced or used for other projects without their permission.



Suite C100 - 4185 Still Creek Drive
Burnaby, British Columbia, V5C 6G9
p: 604 294-0011 ; f: 604 294-0022

SEAL:

NO.	DATE	REVISION DESCRIPTION	DR.
2	18.JY.31	ISSUED FOR DE	MM
1	18.JY.17	NEW SITE PLAN/ COMMENTS	MM

CLIENT:

PROJECT:

RESIDENTIAL DEVELOPMENT

1269 - 1295 W. 8TH AVENUE
VANCOUVER, BC

LANDSCAPE PLAN

DATE: 18.APR.04 DRAWING NUMBER:
SCALE: 1/8"=1'-0"
DRAWN:
DESIGN:
CHK'D: MCY OF 3

PMG PROJECT NUMBER: 18-034

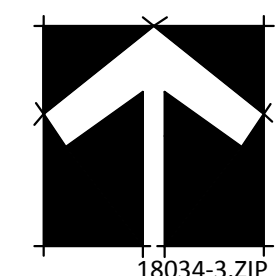

L3