

IMPERMEABLE MATERIAL SITE COVERAGE:

GROSS SITE AREA = 2689.2 SQ. FT (249.83 SQ.M)

IMPERMEABLE AREAS:
 DECKS/ PORCH = 140.00 SQ.FT. (13.00 SQ.M.)
 STAIRS = 103.00 SQ.FT. (9.57 SQ. M.)
 HOUSE = 1380.90 SQ.FT. (128.20 SQ.M.)

TOTAL IMPERMEABLE AREAS PROPOSED = 1616 SQ.FT. (150.13 SQ.M.)
 % IMPERMEABLE AREAS PROPOSED = 60%

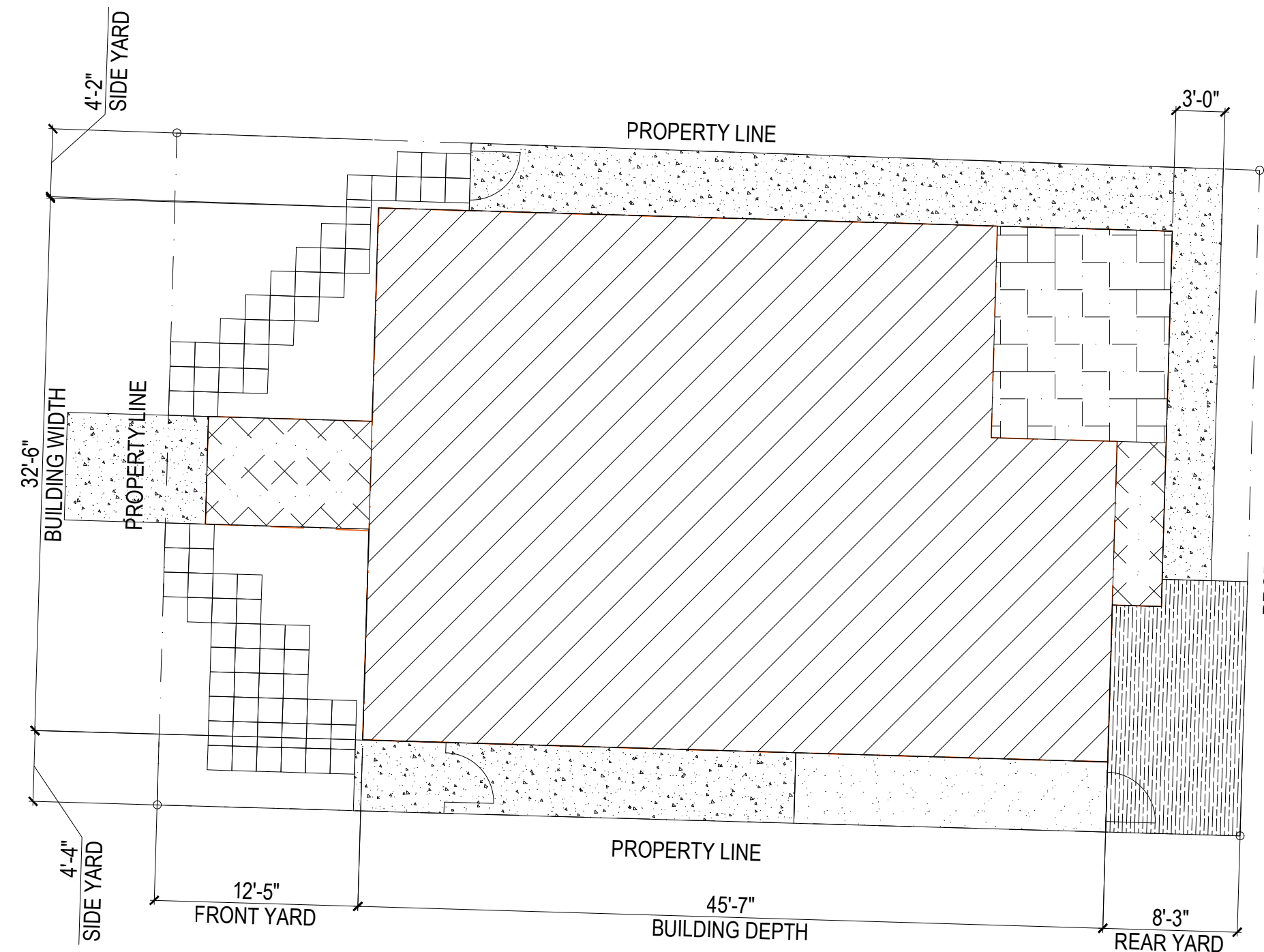

1 SITE COVERAGE AND IMPERMEABLE MATERIAL COVERAGE PLAN
 SCALE 1/8"= 1'-0"



A ISSUED FOR DP 09.01.2017
 No. Description Date

PROJECT TITLE
Sharma Residence
 3120 Ontario Street
 Vancouver, BC

© Copyright reserved. this plan and design is and all times remains the exclusive property of Architelier Architecture + Real Estate Inc. and cannot be used without the architects consent.
 All dimensions on the project must be checked by the contractor.
 This drawing must not be used for construction purposes until here counter-signed.
 aar: date:

NOT FOR CONSTRUCTION

SHEET TITLE
SITE COVERAGE

PROJECT NO. —
 DRAWN Author
 CHECKED DW
 SCALED AS NOTED
 DATE SEPT. 28, 2017
 PRINTED —

REVISION No.

A001

RIDGE HEGHT= 205.8'



HOUSE NO. 3100

RIDGE HEGHT= 205.8'



HOUSE NO. 3104

RIDGE HEGHT= 213.23'



PROPOSED RESIDENCE

2 STREETScape
 SCALE 1/4"= 1'-0"